

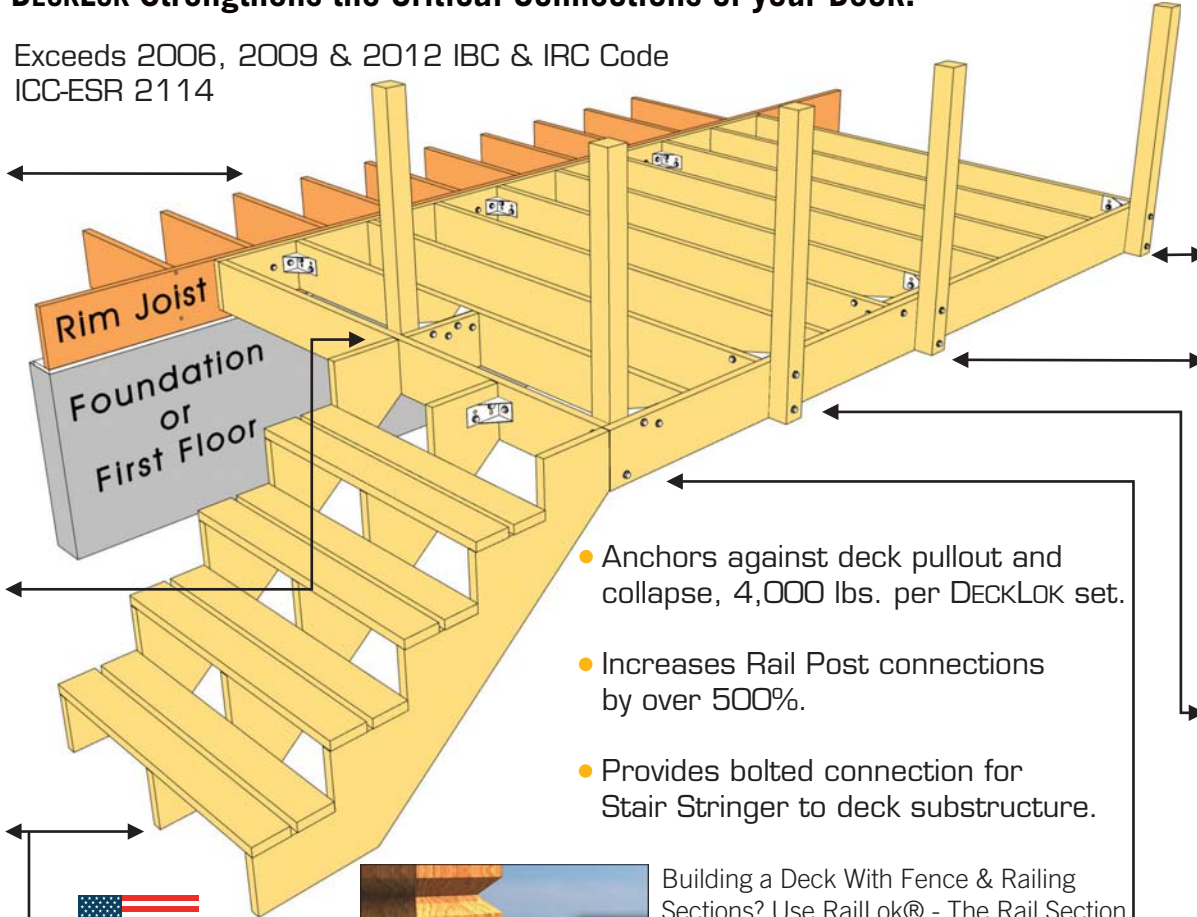

DECKLOK Strengthens the Critical Connections of your Deck!

Exceeds 2006, 2009 & 2012 IBC & IRC Code
ICC-ESR 2114

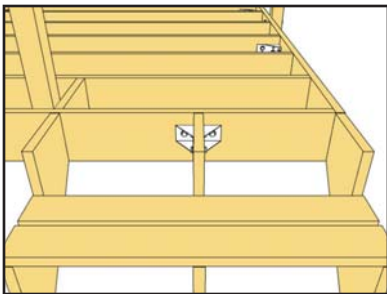
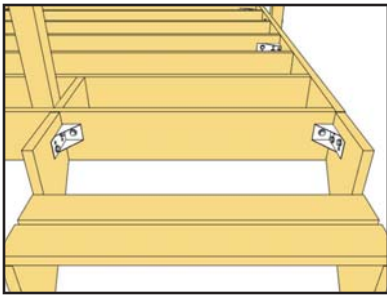
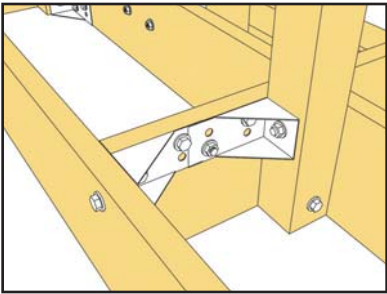
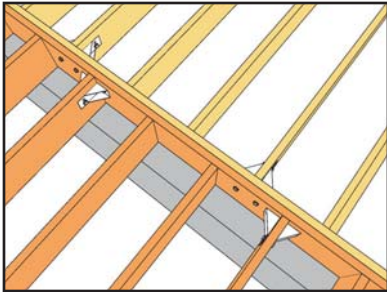

Rim Joist
Foundation
or
First Floor

- Anchors against deck pullout and collapse, 4,000 lbs. per DECKLOK set.
- Increases Rail Post connections by over 500%.
- Provides bolted connection for Stair Stringer to deck substructure.

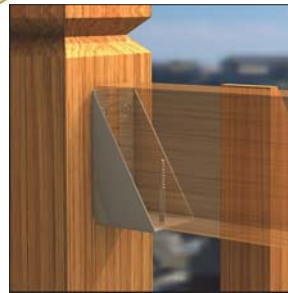

Building a Deck With Fence & Railing Sections? Use RailLok[®] - The Rail Section Connection! RailLok is used to connect railing sections to the rail post. Attach the brackets to the rail post using screws and then slip pre-assembled railing sections into the brackets and screw them in place. RailLok brackets provide a strong, reliable railing to post connection.

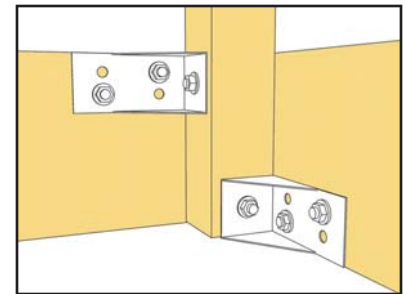
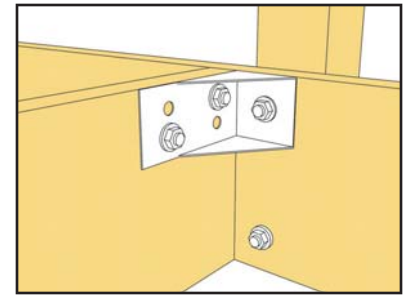
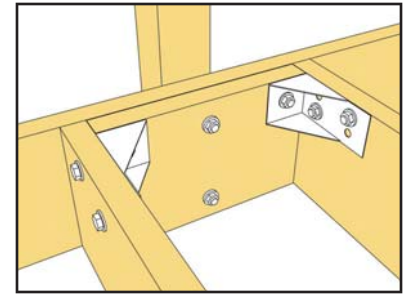
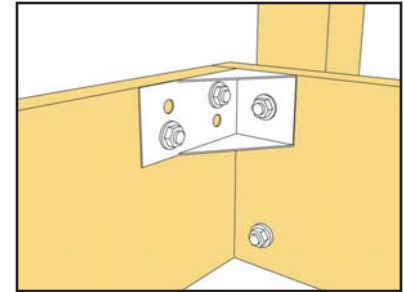

Anchoring Ledger Board To House

From inside the house, mark for the center bolt of the DeckLok Bracket; drill a 1/2" hole through the rim joist and the ledger board. Install a bolt, w/ flat washer, through the center hole in the DeckLok Bracket. Place a min. 1/4" spacer on the end of the bolt and insert the bolt into the drilled hole. Install flat washer and nut tighten to the ledger board. Next, select two diagonally opposed bolt holes; mark and drill through the house floor joist; install two, 1/2" diameter bolts. Repeat center hole steps above for second DeckLok Bracket. Sandwich the house floor joist between the two DeckLok Brackets. Secure using flat washers on both sides, lock washers, and nuts. Tighten.

Rail Post Adjacent to the Deck Joist

Attach the rail post as usual with two 1/2" mounting bolts. Slide a 1/4" min. spacer onto the top bolt; then slide a DeckLok Bracket onto the top bolt, placing the base of the DeckLok Bracket against the band board and the side of the DeckLok Bracket against the deck joist. Select two diagonally opposed bolt holes; mark and drill through the deck floor joist. Install two, 1/2" diameter bolts, flat washers on both sides, lock washers, and nuts. Tighten.

Rail Post Located Between Deck Joists

Install rail post as usual with two mounting bolts. Add blocking, flush with the inside of the deck's band board, between the deck joists where the post will be mounted. Position a single DeckLok Bracket on each side of the joist bay, placing them against the band board. Hold the DeckLok Bracket as close to the top of the deck joist as possible. Mark and drill through the center bolt hole of the DeckLok Bracket. Install bolt with washer from outside, securing inside with washer, lock washer and nut. Tighten. Select two diagonally opposed bolt holes per Bracket; mark and drill through the deck joist, and install two, 1/2" diameter bolts, flat washers on both sides, lock washers, and nuts. Tighten.

Corner Rail Posts

Install rail post with two mounting bolts; one from each direction (one high & one low). Position a DeckLok Bracket on each side of the post bolts to center hole of the DeckLok Bracket, install flat washers, lock washers, nuts, & tighten. Select two diagonally opposed bolt holes; mark and drill through the deck floor joist, and install two, 1/2" diameter bolts, flat washers, lock washers, and nuts. Repeat for second Bracket. Tighten.

Stair Stringers

If Your Stairs Have Only Two Stringers

Installation requires 2 DeckLok Brackets, one per stringer. Place a Bracket against the deck band board and the inside surface of one of the stair stringers. Mark the center hole on the band board and drill a 1/2" hole. Place the bracket back into position against the stair stringer and place a min. 1/4" spacer between the bracket and the band board. Install a 1/2" bolt, w/ flat washer, through bracket, spacer, and deck band board. Mark and drill for two diagonally opposed holes on the stair stringer. Install 1/2" diameter bolts, flat washers, lock washers, and nuts. Tighten. Repeat for the second stringer.

If Your Stairs Have A Center Or More Than Three Stringers

Sandwich the center stringer between two DeckLok Brackets. Mark and drill the center bolt hole for one of the brackets, drilling through the deck band board. Place the bracket back into position against the stair stringer and place a min. 1/4" spacer between the bracket and the band board. Install a 1/2" bolt, w/ flat washer, through bracket, spacer, and deck band board. Select two diagonally opposed bolt holes on the stringer; mark and drill through the stringer, and install two, 1/2" diameter bolts, slide the other DeckLok Bracket onto the two protruding 1/2" bolts, then drill center bolt hole in band board. Add spacer, flat washers, lock washers, and nuts. Tighten.

Instructions For Use With Engineered Lumber; I-Joists

I-Joists must be reinforced with web stiffeners. (See joist manufacturer's guide for recommended details on modifying or strengthening product.) Using construction adhesive, affix and screw block to each side of the web. Follow the general instructions above to install DeckLok Brackets to the reinforced I-Joist.

Instructions For Use With Engineered Trusses

Wood 2" x 4" Trusses must be reinforced with plates made from 1/2" Plywood, cut to the overall height of the truss. (See truss manufacturer's guide for recommended details on modifying or strengthening product.) Using construction adhesive and fasteners, affix and screw a plate to each side of the truss. Follow the instructions above to install DeckLok Brackets to the reinforced truss.

Installation Notes

- Use 1/2" diameter hardware; bolts, flat washers on each side, lock washers, and nuts.
- Triple layer side of bracket mounts towards lateral force.
- Always read and follow the Product Recommendations provided by Treated Lumber Producers.
- Railings - Brackets must always be installed on upper post mounting bolt.

